

PRODUCT DATA SHEET

Aquila series wall mounted version

VAR305

optional equipment



iNEXT



ENTHALPY
EXCHANGER



MODBUS



MODULATED
HEATER



ENERGY
EFFICIENCY*



EPP
MATERIAL

RECUPERATOR FEATURES

- Installation positions – wall-mounted or floor-standing (VKNAR feet required)
- Counter-flow heat exchanger with the efficiency of up to 95%
- Energy-saving fans with Ziehl-Abegg motors
- Automatic bypass, 100% bypass, insulated
- Excellent insulation thanks to an outer housing made of EPP (expanded polypropylene)
- Tight structure preventing odours and contaminants from the exhaust air from entering the supply air
- Wireless control available (iNext module required)
- Equipped with two filters (M5/ISO ePM10) as standard
- Option of using fine filters (F7/ISO ePM1) with a higher filtration class
- Possible use of reusable pre-filter
- Possible interoperation with the air quality, carbon dioxide and humidity sensor (VSPM, VSHC, VSHW)
- Cleanable heat exchanger
- Long service life
- Anti-freeze system
- Scratch resistance of painted parts at a value of 5 H
- Antimicrobial properties of painted elements according to ASTM E2149-13a
- Possible remote control via MODBUS RTU protocol



* In the case of the recuperator AQUILA 305 with an enthalpy exchanger, an additional sensor (VSPM, VSHC, VSHW) is required to achieve energy efficiency class

Supplementary products

LEGS VKNAR



FILTERS

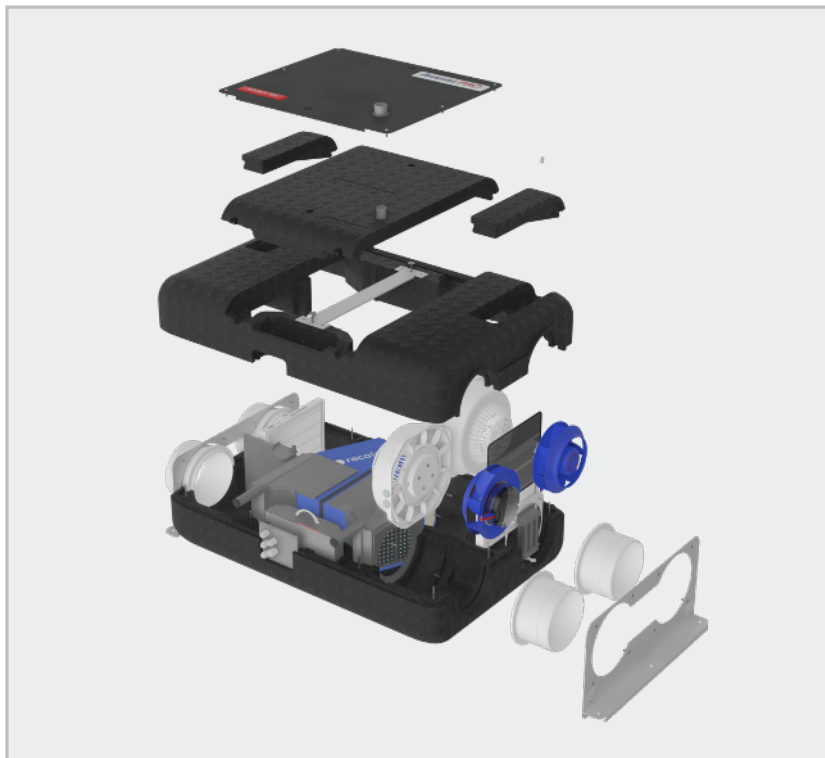

PRODUCT DATA SHEET

Aquila series ceiling mounted version

VARP305

optional equipment



iNEXT



ENTHALPY
EXCHANGER



MODBUS



MODULATED
HEATER



ENERGY
EFFICIENCY*



MATERIAL
EPP

RECUPERATOR FEATURES

- Installation position – ceiling mounted (suspended)
- Counter-flow heat exchanger with the efficiency of up to 95%
- Energy-saving fans with Ziehl-Abegg motors
- Automatic bypass, 100% bypass, insulated
- Excellent insulation thanks to an outer housing made of EPP (expanded polypropylene)
- Tight structure preventing odours and contaminants from the exhaust air from entering the supply air
- Wireless control available (iNext module required)
- Equipped with two filters (M5/ISO ePM10) as standard
- Option of using fine filters (F7/ISO ePM1) with a higher filtration class
- Possible use of reusable pre-filter
- Possible interoperation with the air quality, carbon dioxide and humidity sensor (VSPM, VSHC, VSHW)
- Cleanable heat exchanger
- Long service life
- Anti-freeze system
- Scratch resistance of painted parts at a value of 5 H
- Antimicrobial properties of painted elements according to ASTM E2149-13a
- Possible remote control via MODBUS RTU protocol



* In the case of the recuperator AQUILA 305 with an enthalpy exchanger, an additional sensor (VSPM, VSHC, VSHW) is required to achieve energy efficiency class

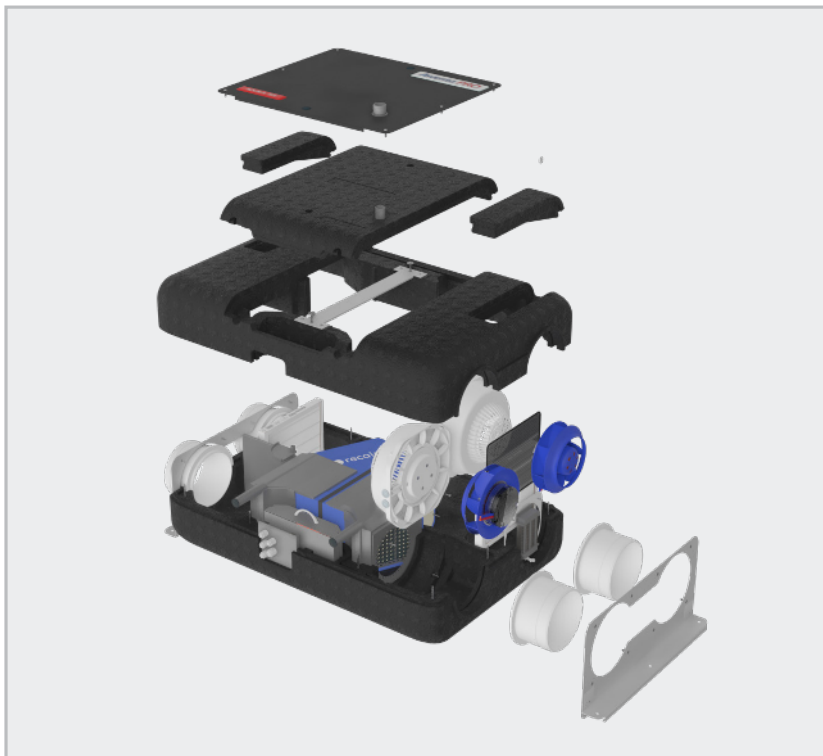

Supplementary products

FILTERS



PRODUCT DATA SHEET

optional equipment



iNEXT



ENTHALPY EXCHANGER



MODBUS



MODULATED HEATER



ENERGY EFFICIENCY*



MATERIAL

Aquila series

VAREP205, VARP305, VARES205, VARS305

Aquila series

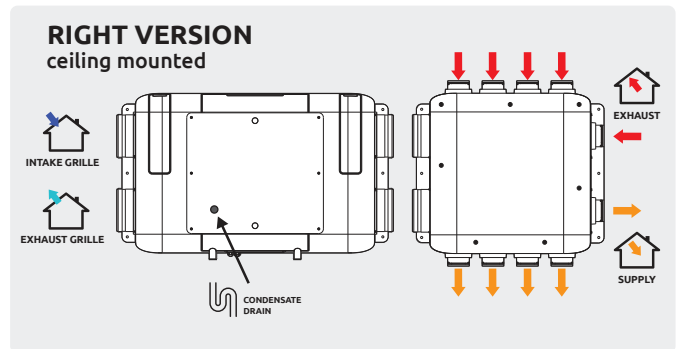
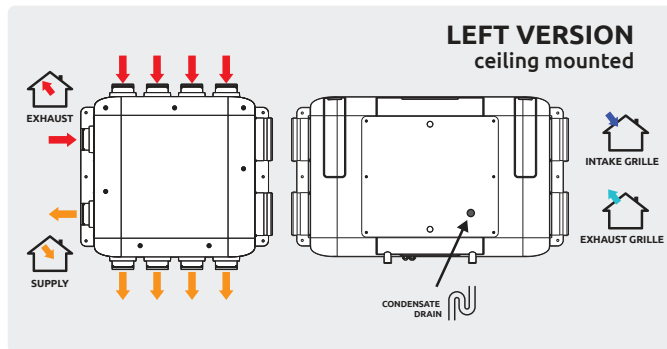
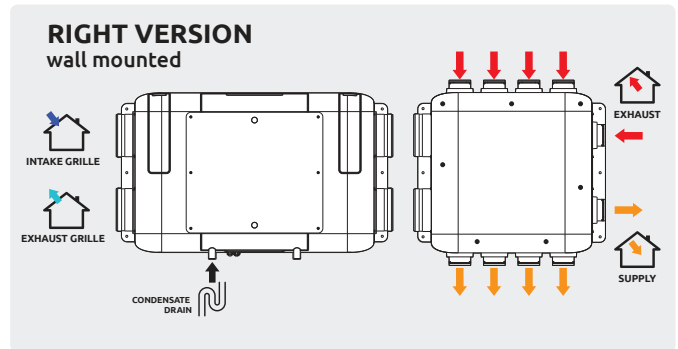
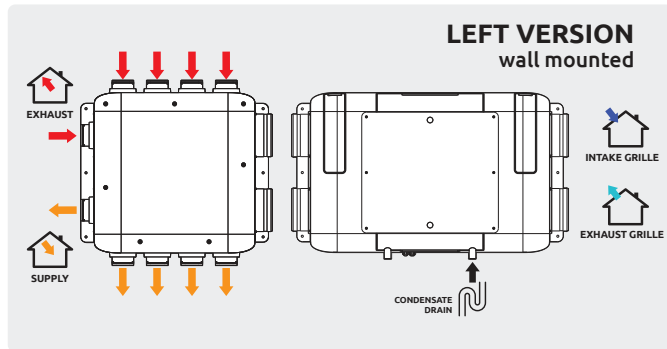

TECHNICAL INFORMATION

INDEX	AQUILA EASY 205		AQUILA 305	
	VARES205	VAREP205	VAR305	VARP305
Supply voltage	230 V AC / 50 Hz			
IP protection class	IP22			
Preheat coil power	none		750 W	
Max. power consumption (without preheat coil)	98 W		200 W	
Capacity (at 100 Pa)	215 m ³ /h		313 m ³ /h	
Maximum engine speed	2900 RPM		3850 RPM	
Maximum Noise level	44 dB(A)		49 dB(A)	
Type of heat exchanger	Countercurrent		Countercurrent	
Max. heat recovery efficiency	up to 95%		up to 95%	
Heat exchanger material	Polystyrene			
Housing material	EPP + powder coated steel			
Filter - intake vent	M5 ISO ePM10 (optional F7 ISO ePM1)			
Filter - exhaust	M5 ISO ePM10			
Pre-filter intake / exhaust	VFWAR (optional)			
Diameter of air connector	160 mm			
Diameter of condensate drain connector	32 mm			
Controller type	AERO 6 + NANO M (monochromatic)		AERO AP + AWENTA CONTROL	
Bypass	Automatic 100%			
Fans	2x radian fan with EC motor			
Modbus RTU Communication	NO		YES	
Internet module	VLAN iNEXT (optional)			
Air quality sensor	NO		VSPM (optional)	
CO ₂ concentration and humidity sensor	NO		VSHC (optional)	
Humidity sensor	NO		VSHW (optional)	
Weight	16kg + 5kg (distribution unit VARR)		16kg + 5kg (distribution unit VARR)	

PRODUCT DATA SHEET

optional equipment



iNEXT



ENTHALPY EXCHANGER



MODBUS



MODULATED HEATER



ENERGY EFFICIENCY*



MATERIAL

Aquila series

VAREP205, VARP305, VARES205, VARS305

Aquila series

AQUILA ceiling mounted version



DIMENSIONS

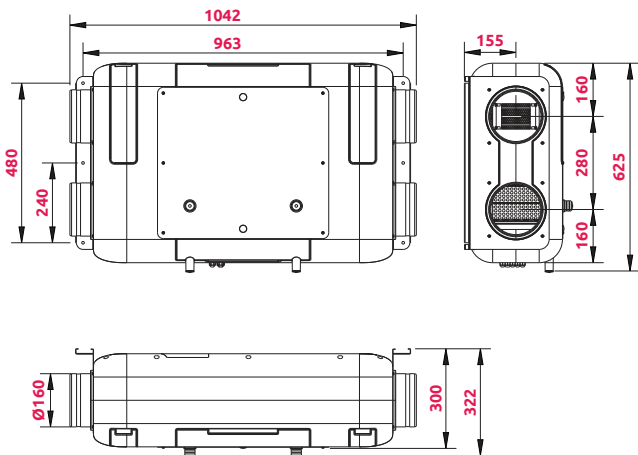
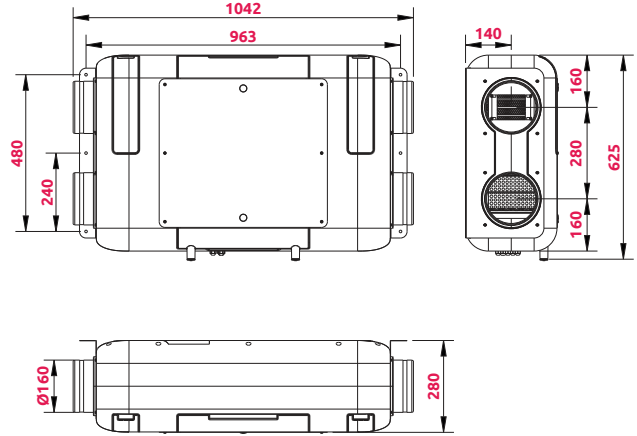

AQUILA wall mounted version



CAPACITY

STANDARD VERSION

ENTHALPY HEAT EXCHANGER VERSION

AQUILA EASY 205

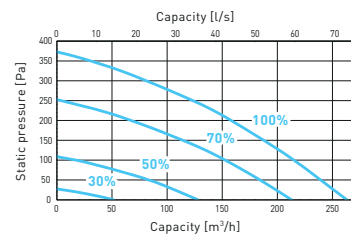
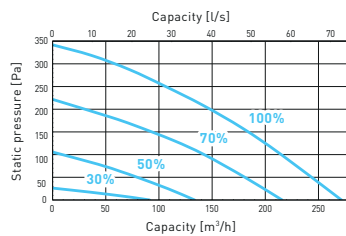

AQUILA 305

